

Model 28 Steel

Designed to offer postural support and a certain degree of restraint to children and adults to keep them in an upright sitting position.

Fits most types of vehicle seating including **single, bench seats & some child booster seats.**

To fit the harness access is required between the seat back and seat cushion to fasten the fixing straps vertically around the back rest.

IMPORTANT: This harness is not classed as a safety harness.

The vehicle safety belt **MUST** be worn over the top of our harness unless they are exempt for medical reasons.

ONE SIZE ONLY - 4 Years to Adult (Approx. 15 Kg Upwards)

This harness will accommodate :-

- Young children using **some** High Backed Booster Seats (e.g. Britax Adventure - see below)
- Children using Booster Cushions
- Passengers above 135cm who are able to sit directly on the vehicle seat.

Britax Adventure



The waist belt on this harness is fitted with a Steel Safety buckle for those passengers with inquisitive fingers that can undo the press release buckle.

Cat. Ref: 28SB



Model 28 can be used on both single & bench seats. It can also be used with Booster Seats & Cushions.



A Houdini Stop is sent with this harness free of charge

This chest strap ensures the passenger stays safely and correctly positioned within their harness.

It simply clips on to each shoulder strap of the harness to help prevent the passenger from separating the shoulder straps in order to escape.

Crelling Harnesses For Disabled Ltd.

12 Crescent East, Thornton-Cleveleys, Lancashire, FY5 3LJ

Tel: 01253 852298 Fax: 01253 821780 Email: info@crelling.com Website: www.crelling.com

Model 28 Fitting Instructions

1. If fitting a brand new harness, remove any Rubber Bands & unfasten the two Vertical Fixing Straps [a].
2. Holding the two Aluminium Bar Buckles [b] (attached to the upper section of the Vertical Fixing Straps) place the back pad of the harness against the front of the seat back & place the Fixing Straps up & over the seat back.



3. Pass the tail-ends of the two lower sections of the Vertical Fixing Straps [a] (on either side of the understrap [f]), down through the gap between the seat back & seat cushion.
Nb. The Understrap should remain lying on the seat cushion.
4. Now feed the tail-ends of the Fixing straps up through the Aluminium Bar Buckles (see diagram [b]) & pull down to tighten around the seat back as securely as possible.
5. Each tail end should then be passed through the Sliplock Slide [c] to prevent the Fixing Straps from loosening during transit.
6. Position the Understrap [f] centrally on the seat cushion
7. If the passenger is under 135cm place a Booster Seat or Cushion on top of the Understrap to comply with child seat safety legislation (See back of Instructions for further information)
8. Position the Back Pad & Body Harness on the seat so that the waist belt will be in line with the waist when the passenger sits down.
9. With the harness unfastened at the waist belt sit the passenger on the understrap / child seat in the most upright position as possible & bring their arms through the shoulder straps [d].
8. Now bring the understrap [f] up between the legs and loop it back onto the waist belt over the buckle [h].
9. Connect the waist belt buckle to fasten the harness. Position the buckle centrally at waist level on the passenger.
10. Adjust all straps to fit tightly yet comfortably by pulling the tail-ends of strapping through the Adjuster Buckles [i].
11. If using the Houdini Stop Chest Strap [j], attach to Shoulder Straps **underneath the Adjuster Buckles** [j]. See instruction provided.
12. Ensure that the three Comfort Pads [g] are in position over the Adjuster Buckles [i] on the Shoulder & Under Straps.
13. **Fasten the vehicle safety belt over the top of the Model 28 Harness.**
14. To remove the passenger from the harness - Unfasten the buckle on the waist belt at the centre-front.

40mm Adjuster Buckle

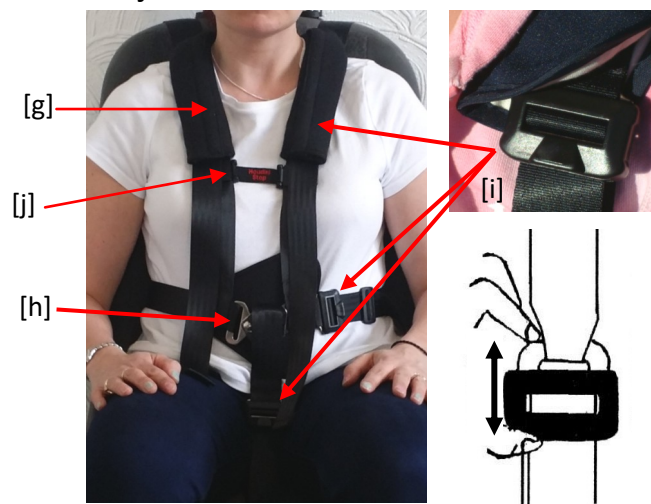

To Extend Straps

The 40mm Adjuster is slightly spring loaded to lock the webbing into position.

To release the webbing you need to squeeze the Adjuster whilst pulling on the lower webbing strap.



To Tighten Straps

Simply pull the tail-end of the webbing strap.

The Adjuster will lock the webbing into position



50mm Aluminium Bar Buckle

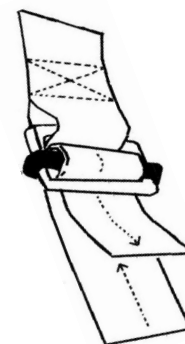
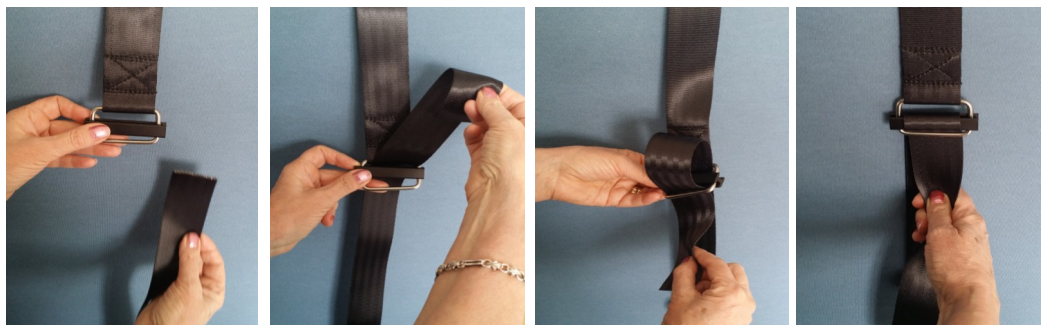

Webbing is threaded through the sliding bar buckle

Sliplock Slide



Loose ends of webbing are often passed back through these slides to prevent slippage & to prevent the Fixing Straps from loosening during transit.

Steel Safety Buckle

This buckle has proven extremely successful when fitted to our harnesses as an alternative to the standard 'quick release' buckle.

It helps prevent those passengers with inquisitive fingers, challenging behaviour or learning difficulties from releasing the harness buckle.

The buckle operates in reverse to the standard vehicle buckles as it is opened by raising a spring loaded lever or over-catch and **will not press release**. The spring loaded over-catch locks the buckle when assembled and prevents accidental opening.

There is a knurled sliding bar for adjustment designed to prevent webbing slip.

The buckle is made from Type 316 Stainless Steel and Nylon 6 and is assembled with tamper proof screws.

The 40mm buckle has a Breaking Strain of 630 kg

We recommend that the buckle instructions provided with each harness are displayed in a prominent position in the vehicle - to instruct the carer how to release the buckle mechanism in the event of an accident.

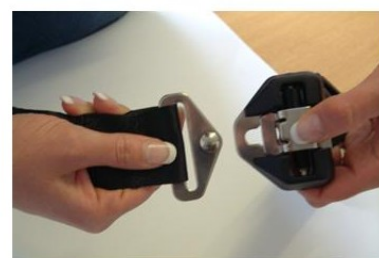
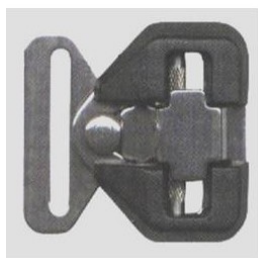

Emergency Seat Belt Cutter (Optional Extra)

We strongly recommend that a seat belt cutter is kept in the vehicle as a safety precaution for those harnesses fitted with a Steel Safety Buckle.

A simple but effective device for ensuring the occupants of a car are able to exit quickly and safely, particularly in the overturned car.

It is perfectly safe as the blade is encased.

Cat. Ref: SK



Comfort Sleeves

Velcro Comfort Sleeves will be supplied with each harness.

These can be fitted around the shoulder Straps & under strap where required.



Booster cushions



All our range of children's vehicle harnesses can be used in conjunction with booster cushions

Booster Seats

IMPORTANT: Our harnesses must NOT be used with child car seats already fitted with the 5 point harness.



Height-adjustable
headrest

Britax Adventure
15 to 36kg (approx. 4 to 11 years)

The **Model 28** harness can be used on some high backed booster seats with height-adjustable headrests, which extend to grow with the child such as the **Britax Adventure**.

Some of our customers have found that they work very well together offering postural support or extra security for those with learning difficulties.

- The **model 28 harness is fitted directly onto the vehicle seat first**, prior to fitting the high backed booster seat.
- The high backed booster seat is then fitted onto the vehicle seat.
- The shoulder straps and waist belt of the Crelling harness are then brought around the booster seat.
- The shoulder straps should slot between the shoulder of the booster seat & the head rest.
- The harness is now ready for the child to get into.
- Place the child into the booster seat & fasten the harness according to the [Model 28 fitting instructions](#).
- Once the child is securely & comfortably fastened in the harness, **fasten the vehicle seat belt over the top of our harness** ensuring that it passes through the 'belt guides'.
- Please ensure that the high backed booster seat is fitted according to the manufacturers instructions & the head rest is adjusted correctly. A properly adjusted headrest ensures the optimum distribution of the diagonal belt & provides your child with the desired protection and comfort.



Model 28 - will fit both **single** and **bench** seats, as long as there is access between the seat cushion & back rest of the vehicle seat to pass the fixing straps vertically around the back rest.

IMPORTANT: This harness is not classed as a safety harness.

The vehicle safety belt **MUST** be worn over the top of our harness unless they are exempt for medical reasons. The combination of the existing safety belt & the secondary harness offers added security for the passenger.